

Mechanical:

REV.	ECN NO.	DESCRIPTION	DATE	APPD
A	REL		2009/09/09	

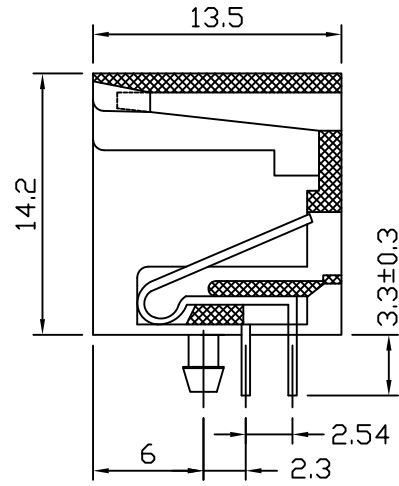

- PCB JACK Specification
1. Insulation Resistance: 500MΩ MIN @ 500 VDC
  2. Withstanding Voltage: AC1000V 50Hz or 60Hz 1min.
  3. Durability: 600 Mating Circles MIN.
  4. Gold Plating:  
(Gold Flash; 1.5;3;6;15;30;50)U" Inch
  5. (1) Storage: -40°C to +85°C  
(2) Operation: -40°C to +85°C  
(3) Wave solder temperature: 230°C to 250°C, 5~10 Sec.

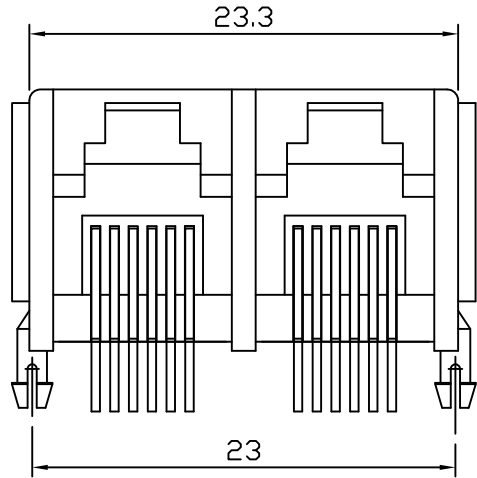
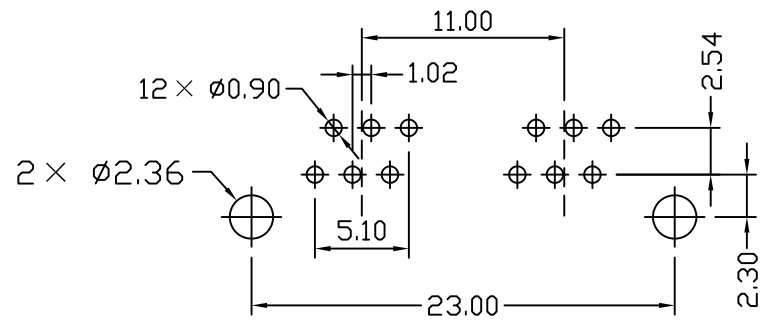
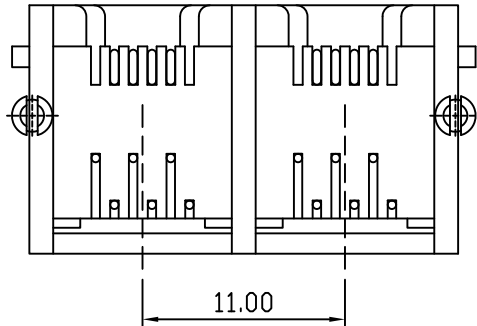

PC Board Layout (Top View)

X:X ±0.30	APPD:	LINK-PP INT'L TECHNOLOGY CO., LIMITED		
X:XX ±0.25	CHKD:	TITLE: RJ11 1×2 CONNECTOR (6P 6C)		
X:XXX ±0.05	DR: TOM	PART NO.: LPJE704NNL		
ANGLES ±1°	UNIT: mm			
	SCALE: 2/1	SHEET: 1/1	REV: A	DWG NO.: LP09090910