

REW.	ECN NO.	DESCRIPTION	DATE	APPD
A	REL		16/12/2009	

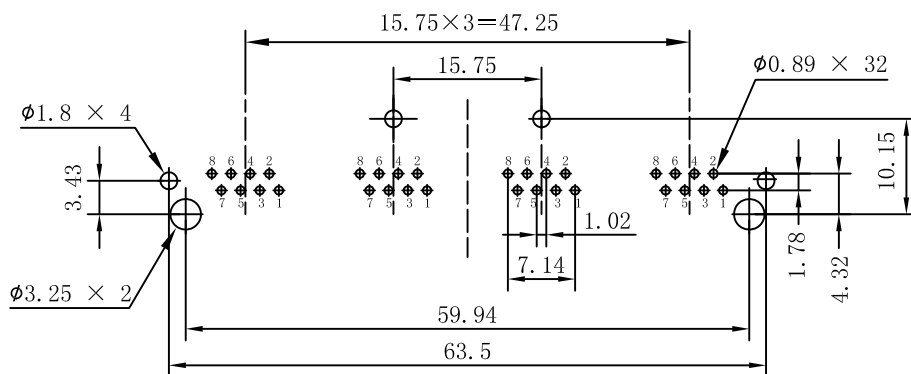
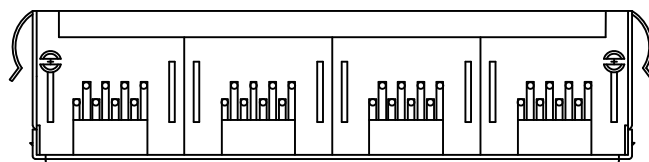
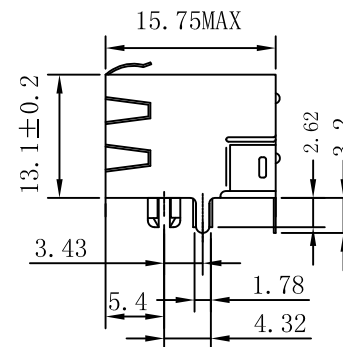
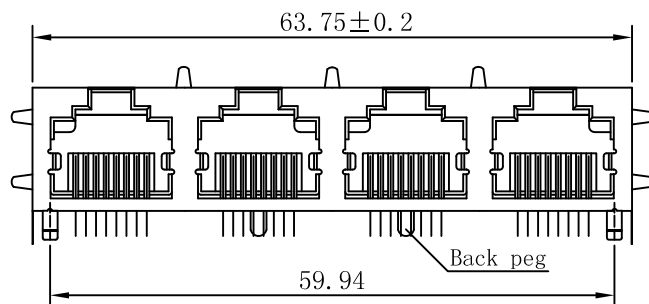

PC Board Layout (TOP VIEW)
Component Side Shown

NOTES:
MATERIAL:

- HOUSING MATERIAL
- CONTACT MATERIAL
- PLATING
- SHIELD

: GLASS FILLED POLYESTER UL94V-0.
: PHOSPHOR BRONZE $\phi 0.46$ mm.
: GOLD PLATING OVER NICKEL.
: 0.23mm THICKNESS COPPER ALLOY WITH NICKEL PLATED.
: OPTION

ELECTRICAL:

- VOLTAGE RATING
- CURRENT RATING
- CONTACT RESISTANCE
- INSULATION RESISTANCE
- DIELECTRIC WITHSTANDING RESISTANCE

: 125VAC RMS.
: 1.5AMP.
: 30 MILLIOHMS MAX.
: 500MEGOHMS MIN @ 500V DC.
: 1000V AC RMS 50Hz. 1MIN.

MECHANICAL:

- DURRABILITY
- PCB RETENTION PRE-SOLDER

: 750 CYCLES MIN.
: 1LB MIN.

GOLD PLATING:

- GOLD FLASH 1.5U"
- 15U" 30U"

3U" 6U"

50U"

ENVIRONMENTAL:

- STORAGE
- OPERATION

: -40°C TO +85°C.
: -40°C TO +85°C.



X:X	±0.30	APPD:	LINK-PP INT'L TECHNOLOGY CO., LIMITED	
X:XX	±0.25	CHKD:	TITLE: SIDE ENTRY PCB JACK WITH SHIELD	
X:XXX	±0.05	DR: TOM	PART NO.: LPJE401CNL	
ANGLES	±1°	UNIT: mm		
	SCALE: 1/1	SHEET: 1/1	REV: A	DWG NO.: LP09121604