

Mechanical:

REV.	ECN NO.	DESCRIPTION	DATE	APPD
A	REL		2010/05/24	

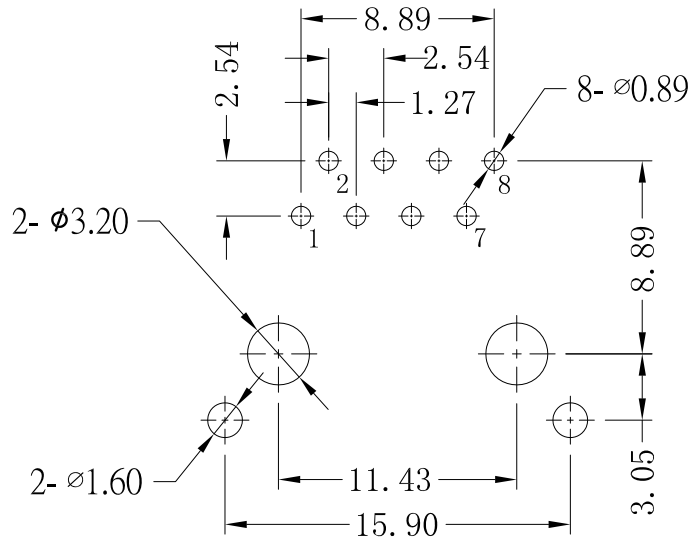
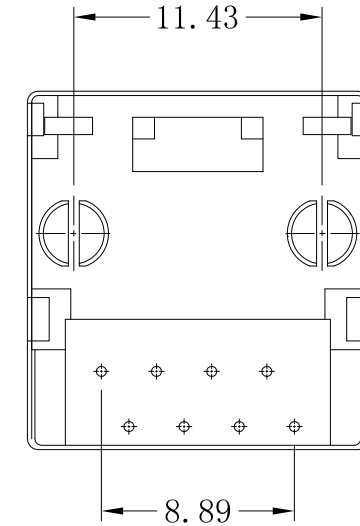
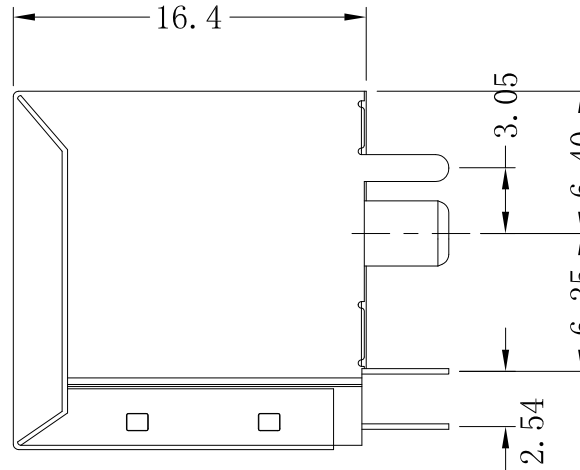
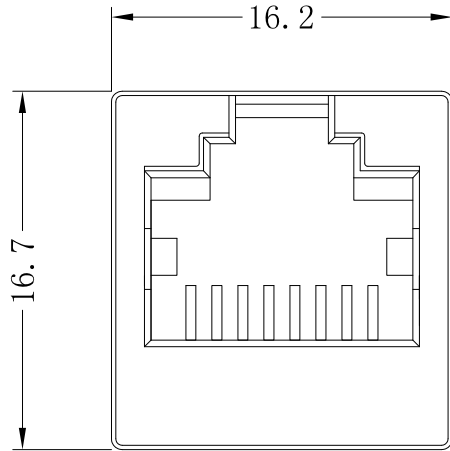

SUGGESTED PCB LAYOUT (TOP VIEW)

LPJE601XDNL

Gold Plating	"X"
Gold Flash	0
1.5u"	1
3u"	2
6u"	3
15u"	4
30u"	5
50u"	6

NOTES:

Electrical:

- Voltage rating : 125 VAC RMS
- Current Rating : 1.5 AMP
- Contact resistance : 50 mΩ Max
- Insulation resistance : 500 MΩ Min @500V DC
- Dielectric strength : 1000 VAC RMS 60Hz, 1MIN.

MECHANICAL:

- Housing & Insert Material : LCP UL94V-0.
- Contact Material : Phospor bronze T=0.35mm
- Shield : 0.20-0.25mm Thickness Brass With tin Plated
- Operating Life : 750 Cycles Min.

ENVIRONMENTAL:

- Storage : -40°C ~ +85°C
- Operation : -40°C ~ +85°C.
- Wave solder temperature : 265°C 5 Sec MAX



X:X	±0.30	APPD:	LINK-PP INT'L TECHNOLOGY CO., LIMITED
X:XX	±0.25	CHKD:	
X:XXX	±0.05	DR: TOM	TITLE: RJ45 1×1 CONNECTOR
ANGLES	±1°	UNIT: mm	PART NO.: LPJE601XDNL
	SCALE: 2/1	SHEET: 1/1	REV: A DWG NO: LP10052412